

**NOTICE OF PUBLIC HEARING  
ON PROPOSED CREATION OF TAX  
INCREMENTAL DISTRICT AND  
PROJECT PLAN**

PLEASE TAKE NOTICE that the Planning Commission of the City of Muskego, Waukesha County, Wisconsin, will hold a public hearing on Tuesday, November 6, 2007, at 6:00 p.m. at City Hall, W182 S8200 Racine Avenue, Muskego, Wisconsin, regarding the proposed creation of a tax incremental district in the City of Muskego, the proposed boundaries thereof and the proposed project plan for the tax incremental district. A map of the boundaries of the proposed tax incremental district is set forth attached.

At the public hearing interested parties will be afforded a reasonable opportunity to express their views on the proposed creation of the tax incremental district, the proposed boundaries thereof and the proposed project plan. The proposed project plan's project costs are expected to include cash grants by the City to owners, lessees or developers of land within the district.

A copy of the proposed project plan will be provided on request at the Planning Department, City of Muskego, W182 S8200 Racine Avenue, Muskego, Wisconsin.

Plan Commission  
City of Muskego

Publish in the Muskego NOW Newspaper on October 18, 2007 and October 25, 2007.

Dated this 11<sup>th</sup> day of October, 2007

NOTICE

IT IS POSSIBLE THAT MEMBERS OF AND POSSIBLY A QUORUM OF MEMBERS OF OTHER GOVERNMENTAL BODIES OF THE MUNICIPALITY MAY BE IN ATTENDANCE AT THE ABOVE-STATED MEETING AND GATHER INFORMATION; NO ACTION WILL BE TAKEN BY ANY GOVERNMENTAL BODY AT THE ABOVE-STATED MEETING OTHER THAN THE GOVERNMENTAL BODY SPECIFICALLY REFERRED TO ABOVE IN THIS NOTICE.

NOTICE

"Please note that, upon reasonable notice, efforts will be made to accommodate the needs of disabled individuals through appropriate aids and services. For additional information or to request this service, contact Janice Moyer at City Hall, W182 S8200 Racine Avenue, (262) 679-5625."

# TID #10 - Location Map

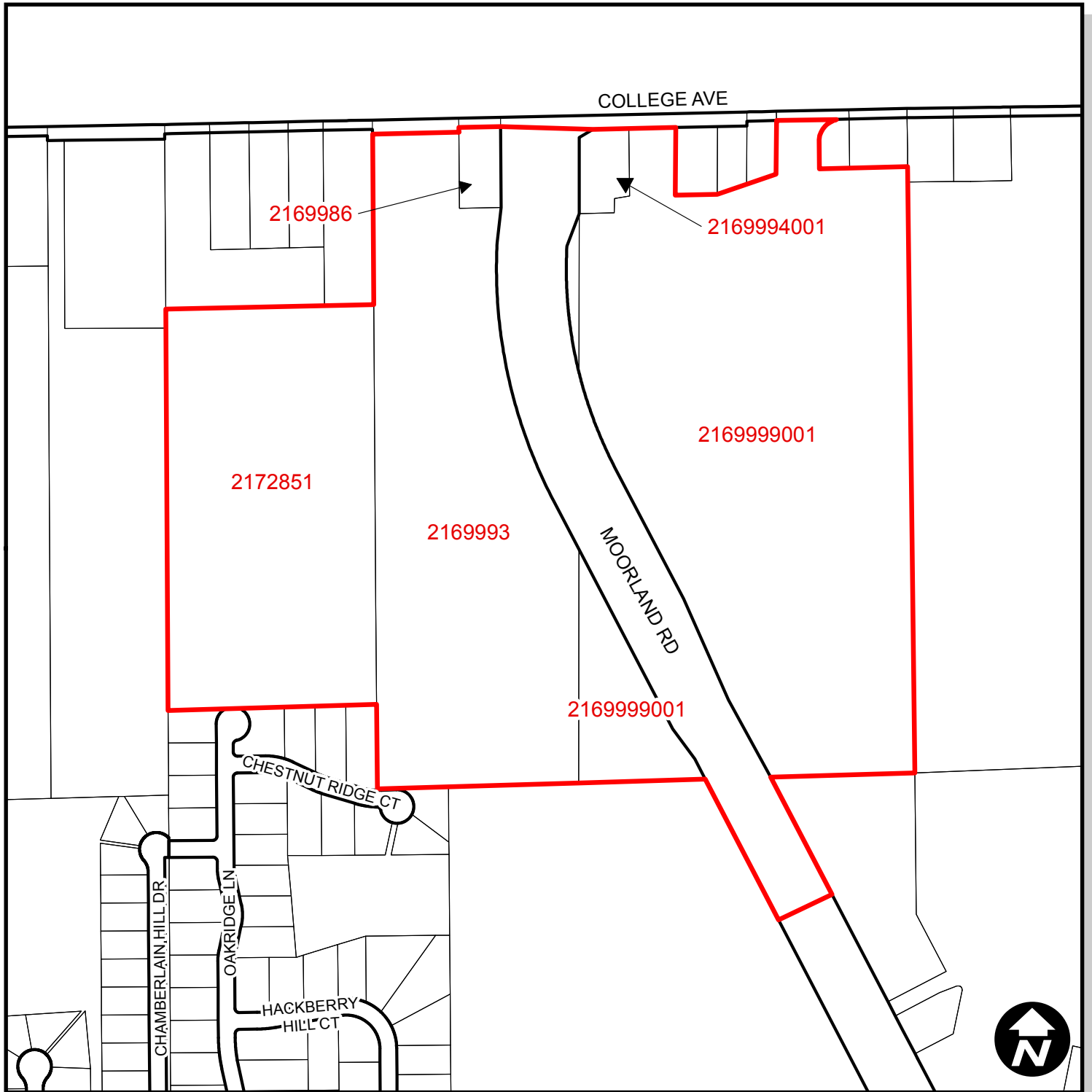

## LEGEND



TID #10 Boundary



Parcel Boundary

2169993 Tax Key Numbers

0 250 500 1,000 Feet



1 inch equals 500 feet

Created By:  
City of Muskego  
Planning Department

